

## Stone/Solid Benchtops

### NOTE:

- if wall mounted tapware is to be used, consideration should be made to length of outlet and positioning of sink in bench top.
- if tapware is to be bench mounted allow suitable bench top width for fitting tapware.

1. Use the template provided to trace the cutout on both the benchtop and underlay/timber lining.



2. Cutout benchtop and underlay/timber lining.

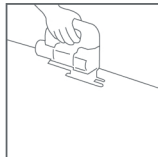

3a. **If using sandwich technique**, silicone both the underneath rim of the undermount bowl and around the underlay/timber lining cutout.

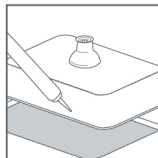

3b. **If using fixing clips**, follow instructions for wooden/laminate benchtops or affix wooden blocks to underside of benchtop to screw fixing clips into.

4. Place sink into position

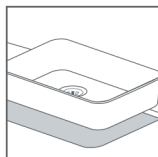

5. Silicon around the lip of the sink to seal between the benchtop and sink surfaces.

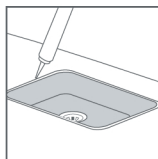

6. Finish by placing benchtop back in position, sandwiching bowl between benchtop and underlay/timber lining.

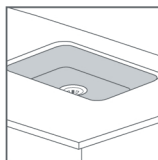

## Wooden/Laminate Benchtops

### Note:

- if wall mounted tapware is to be used, consideration should be made to length of outlet and positioning of sink in bench top.
- if tapware is to be bench mounted allow suitable bench top width for fitting tapware.

1. Use the template provided to trace the cutout on both the benchtop and underlay.



2. Cutout benchtop and underlay.

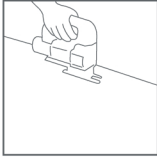

3b. Position sink underneath benchtop and mark out position for fixing clips.



4. Apply sealant/adhesive to rim of sink and position underneath benchtop. Install all securing clips and remove excess sealant.

